

BEAUTIFUL
FLATS
NOW IN YOUR
BUDGET

RERA NO. P53100022800

Amey Prasad

- LIFT WITH BATTERY BACKUP
- COVERED PARKING AREA
- LUXURIOUS SPECIFICATION
- ELEGANT ELEVATION FOR BUILDING

1 BHK	525 / 605 Sqft.
2 BHK	780 sqft.



Ameya Samarth Developers

Suresh Keripale

9423267846

9130459191

Site : Survey No. 7, Plot No. 9, Rajashri Shahu Nagar, Vijaynagar, Wanlesswadi, Sangli.

Amey Prasad

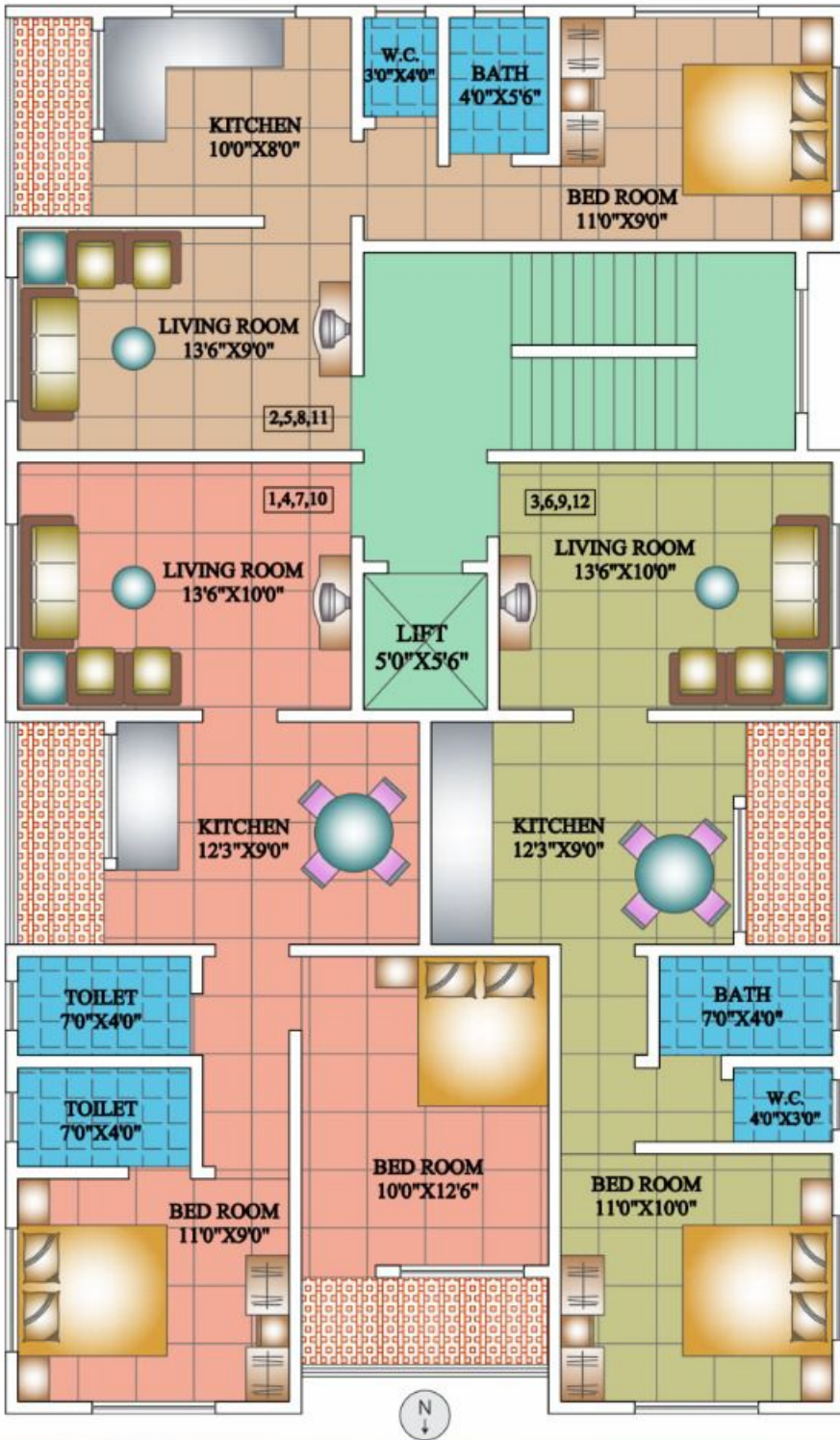

LOCATION MAP



1 BHK	525 / 605 Sqft.
2 BHK	780 sqft.



Ameya Samarth Developers

Suresh Keripale
9423267846

Mohan Desai
8208569715

Suhas Kulkarni
9075975595



Office : Ground Floor, Pushkraj Bhavan, Sphurt Chowk, Government Colony, Sangli. E-mail : sureshkeripale1971@gmail.com

Booking Contact : 9130459191, 9420676679