



# *Akruti* HEIGHTS



2 BHK HOMES

MahaRERA Registration Number: P52600029746

akruti constructions

S.A.GARAD, B.R.BIRLA, S.M.PHULARI





## Amenities & Specifications

### STRUCTURE

- Earthquake resistant RCC frame structure
- 6” thick external and 4” internal Red Brick walls
- Internal plaster in sand finish

### FLOORING

- 600X600 mm vitrified tiles' flooring and skirting for the entire flat
- Ceramic tile flooring for terraces and dry balconies.
- Anti skid ceramic tiles flooring for toilets and Bathroom.

### KITCHEN

- Black Granite platform with stainless steel sink
- Ceramic tiles dado above kitchen platform

### DOORS AND WINDOWS

- Decorative main door with exclusive fittings
- Powder coated aluminum windows
- Internal flush doors with S.S. fittings
- All windows with Granite sills

### PAINTING

- Oil bond distemper paint for inside walls
- External Apex paint

### ELECTRICAL

- Renowned modular switches for the entire flat
- Concealed multi strand fire resistant polycab wires with mcb
- TV point in living room and extra point in 2 bhk master bedroom

### TOILETS

- Wall tiles in bathrooms
- Wash Basin in all flats

### VALUE ADDITION

- SS Railings

### AMENITIES STRUCTURE

- Earthquake proof R C.C. Structure.

### BATHROOM

- Ceramic tiles

### VALUE ADDED FACILITIES

- Sufficient water supply through overhead & under ground tank.
- Video Door Bell
- Loft for every Bedroom
- Two Lifts for Building with Battery Backup
- Solar system for common lights

### SILENT FEATURES

- A Class quality construction.
- Site location in well planned developed area.
- Common Parking.
- Lift Back-up.
- CCTV security system
- Letter box and Name board in parking



# THE ORIGIN OF ENLIGHTENED LIVING





*Enjoy the lifestyle of your dreams*



2 BHK



2 BHK



2 BHK



2 BHK



2 BHK



2 BHK

The great infrastructure has been complimented by affordable homes of

*akruti constructions*

Living will acquire an all-new meaning here, a residential & commercial project that is going to be an apt manifestation of your dream adobes.









**GROUND FLOOR**

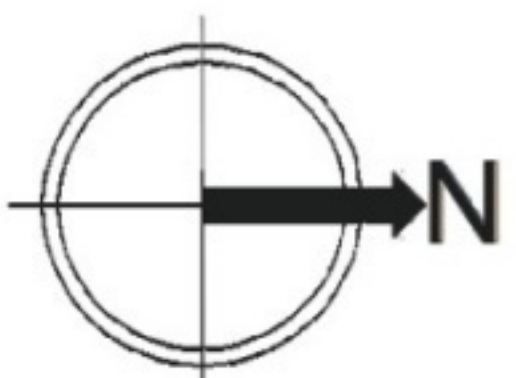



FIRST FLOOR

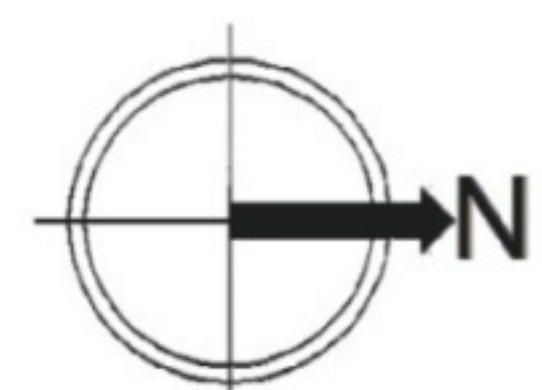



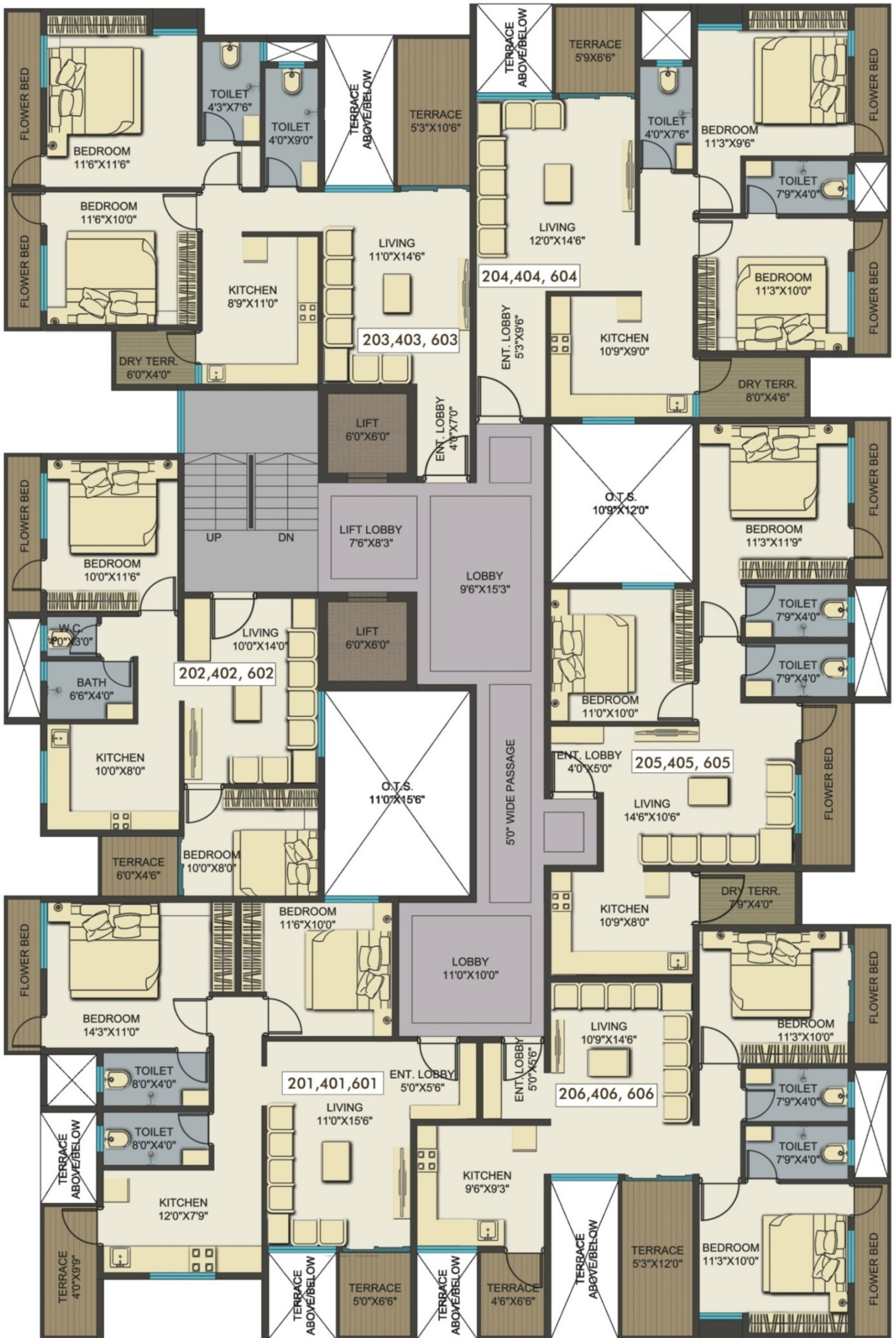

**TYPICAL FLOOR 2nd, 4th & 6th**

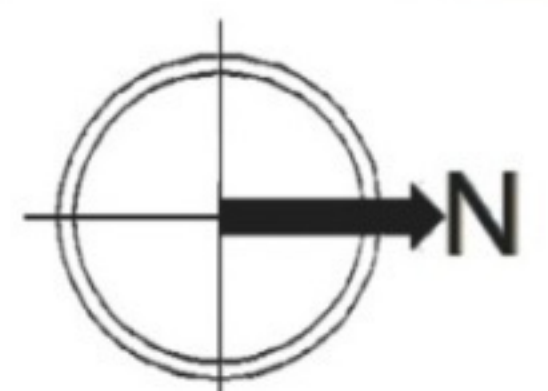



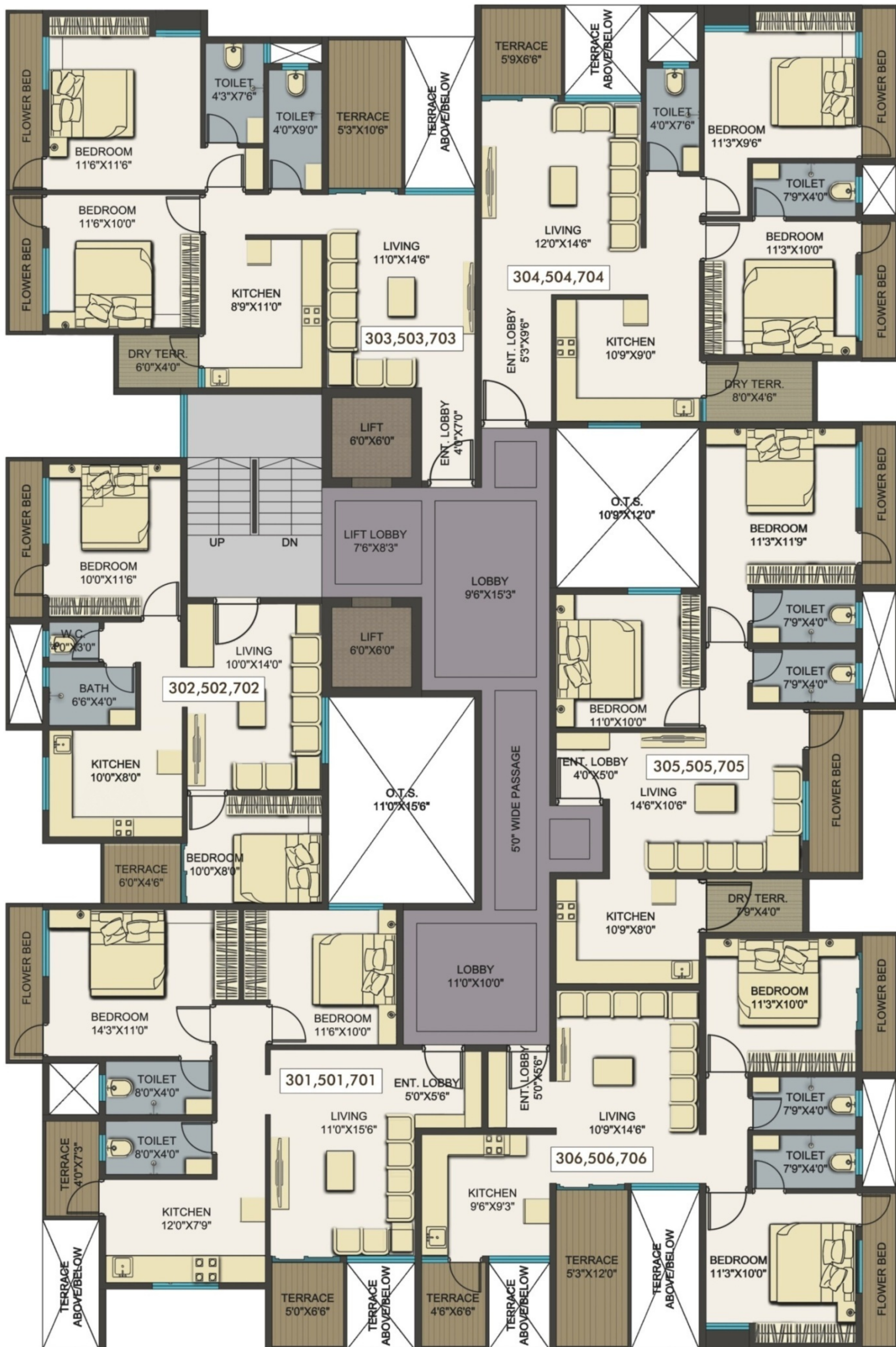

**TYPICAL FLOOR 3rd,5th & 7th**

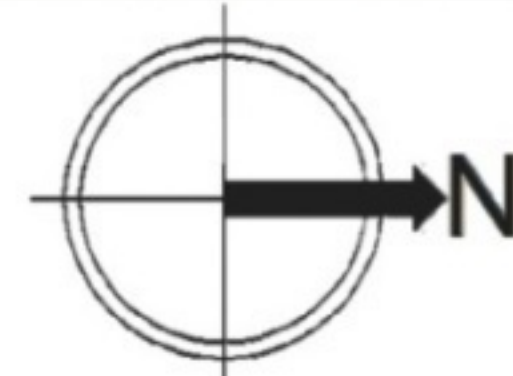



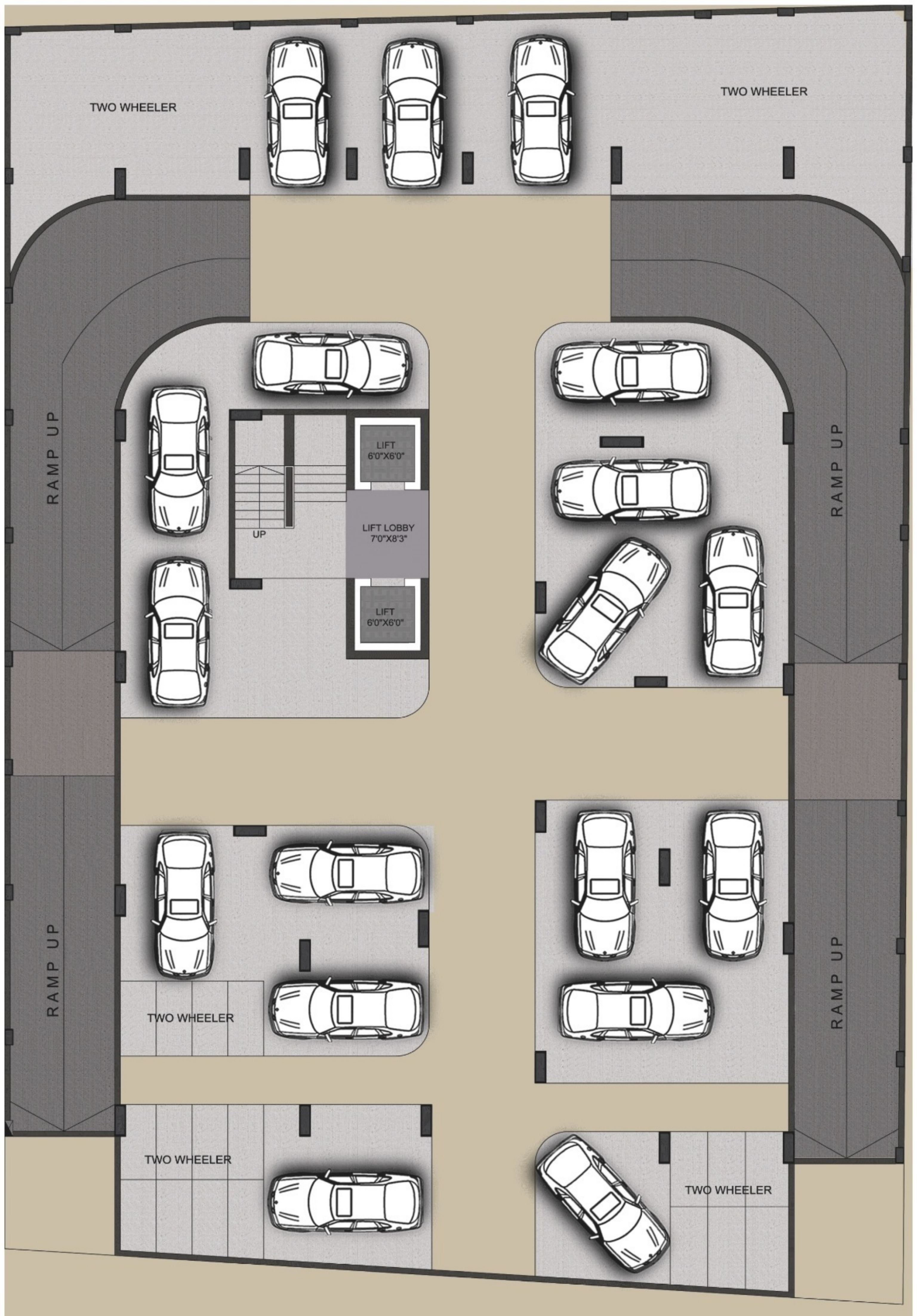

# BASEMENT / PARKING

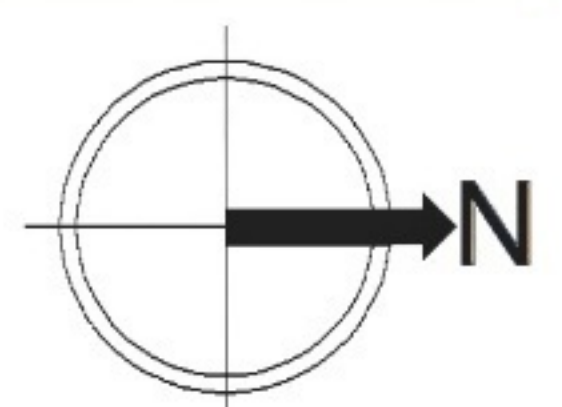







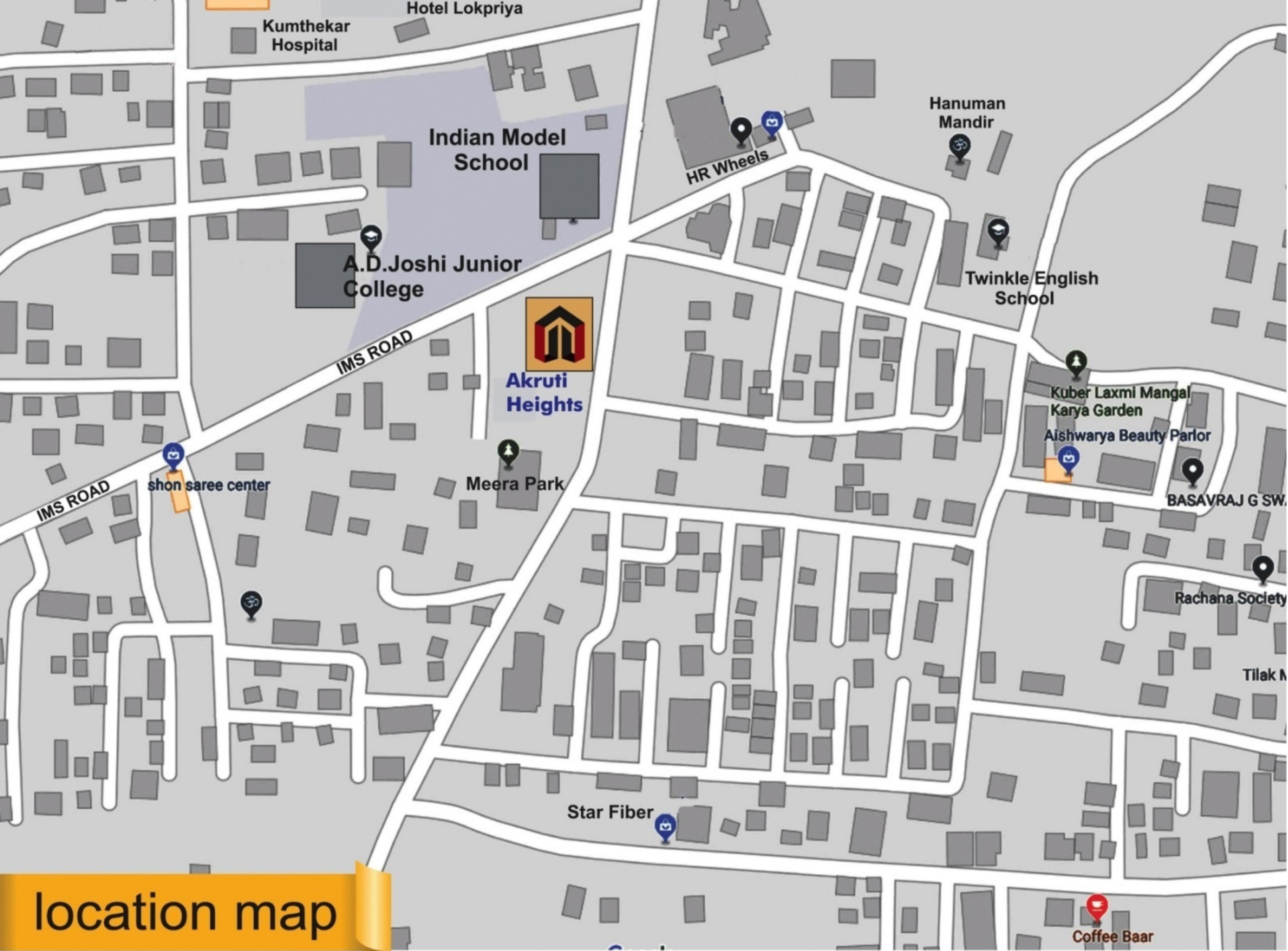

location map



SCHOOLS, COLLEGES  
& INSTITUTES



MARKET



QUICK HIGHWAY  
ACCESSIBILITY



HOSPITAL



HOTELS



BANK & ATM

A Project By:  **akruti  
constructions**  
BUILDERS AND DEVELOPERS

Booking Contact

**S.A.GARAD**  
**8805285555**

**B.R.BIRLA**  
**9960177110**

**S.M.PHULARI**  
**9371583874**

CREDITS

**Architect**  
**TAUHID SHAIKH**

**R.C.C Consultant**  
**JITENDRA BAGALKOTI**

**Legal Advisor**  
**Adv.P.L.DESHMUKH**

**Site Add:- 52,Chandralok Nagari,Near Indian Model School,Jule Solapur.**

star media group | 9922973007