

PADMAVEERA

CITY

Enriching Life

THE PINNACLE OF OPULENT EXISTENCE

The splendor and craftsmanship of the era are displayed right here in Padmaveera City using hues and patterns that are directly drawn from our own rich cultural heritage.





CHERISH
EVERY ASPECT
CELEBRATE
EVERY MOMENT

The project specification and design are the best in class in Jaysingpur City. It is the best abode in our signature style, with the safe, luxurious and gorgeous landscape in and around.





WHERE CLASSIC LUXURY MEETS MODERN COMFORTS.

The ultimate living experience unfolds with the best in class amenities of the area, with the finest offerings and an ease of life, unlike ever before.



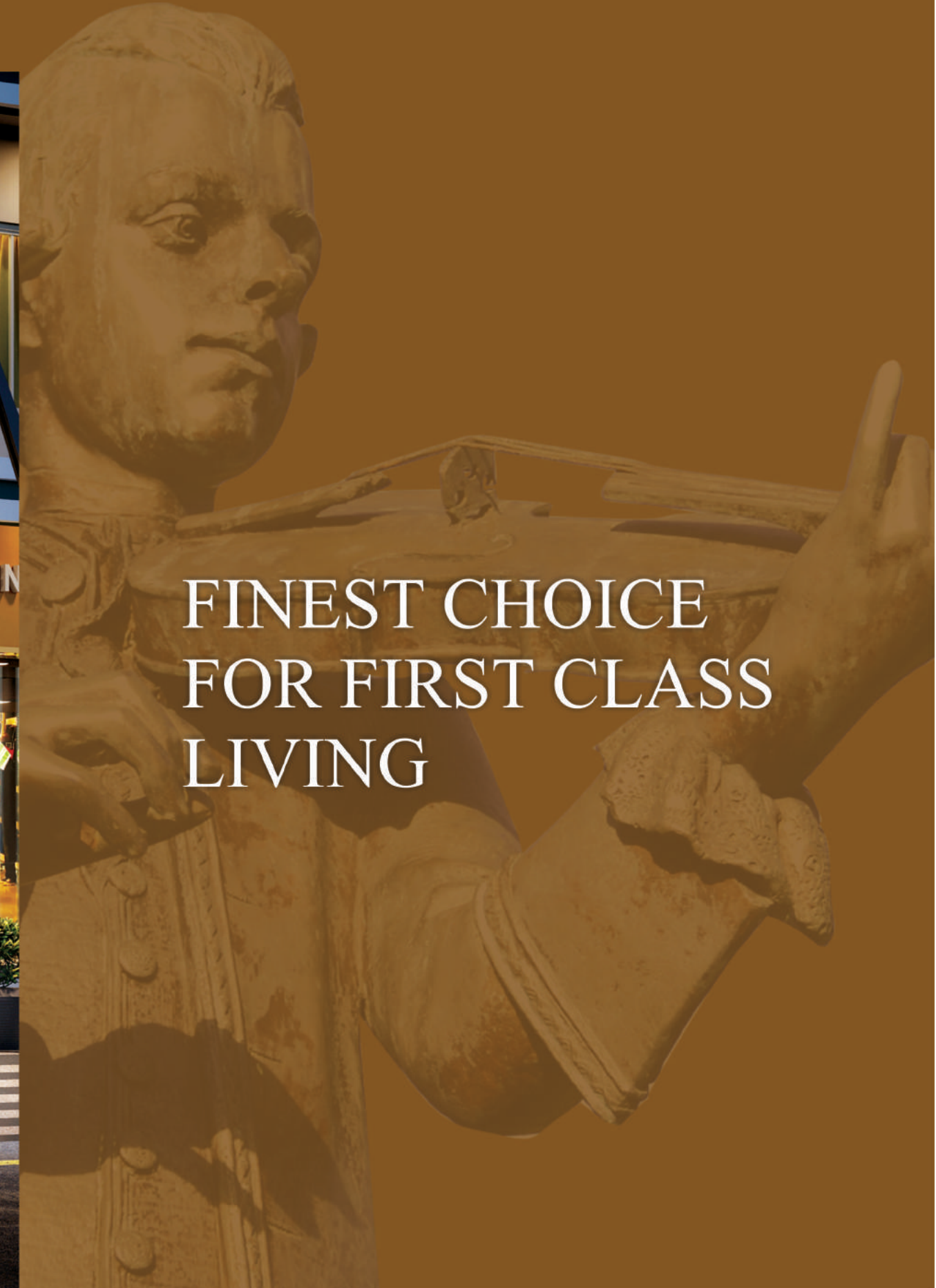

FINEST CHOICE
FOR FIRST CLASS
LIVING

Prominent suburbs of Jaysingpur are close by and with several schools, hospitals, banks and offices situated in the vicinity, the project is a preferred choice for home seekers.



WELCOME TO YOUR NOBLE ABODE.

Bask in a vastu-compliant living space that resonates opulence and charm.



Padmveera City offers homes that are beautiful in every sense, with incredibly spacious rooms, and views that overlook the horizon. Detailed with the finest finishing, it brings you un compromised luxury at every turn.

“Enjoy the ultimate convenience with all amenities at your fingertips”

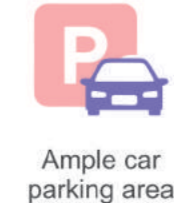
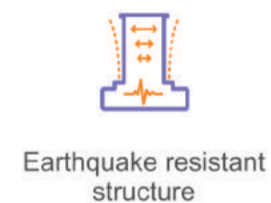
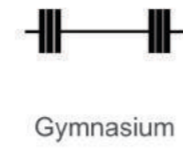

HEALTHY LIFESTYLE.

“Everything you need, right where you are.”

Market & Malls
Vegetable Market - 0.5 Km.
D Mart - 2 Km.

Education
School & College - 1 Km.
J.J. Magdum Engg. - 1.8 Km.

Transportation
Bus Stand - 1.2 Km.
Railway Station - 0.3 Km.

Temple
Siddheshwar Mandir - 0.5 Km.
Datta Mandir - 0.10 Km.
Jain Mandir - 0.40 Km.

Hospital
Sanjivani Hospital - 0.4 Km.
Hiremath Hospital - 0.5 Km.

Highway
Sangli Bypass - 0.5 Km.



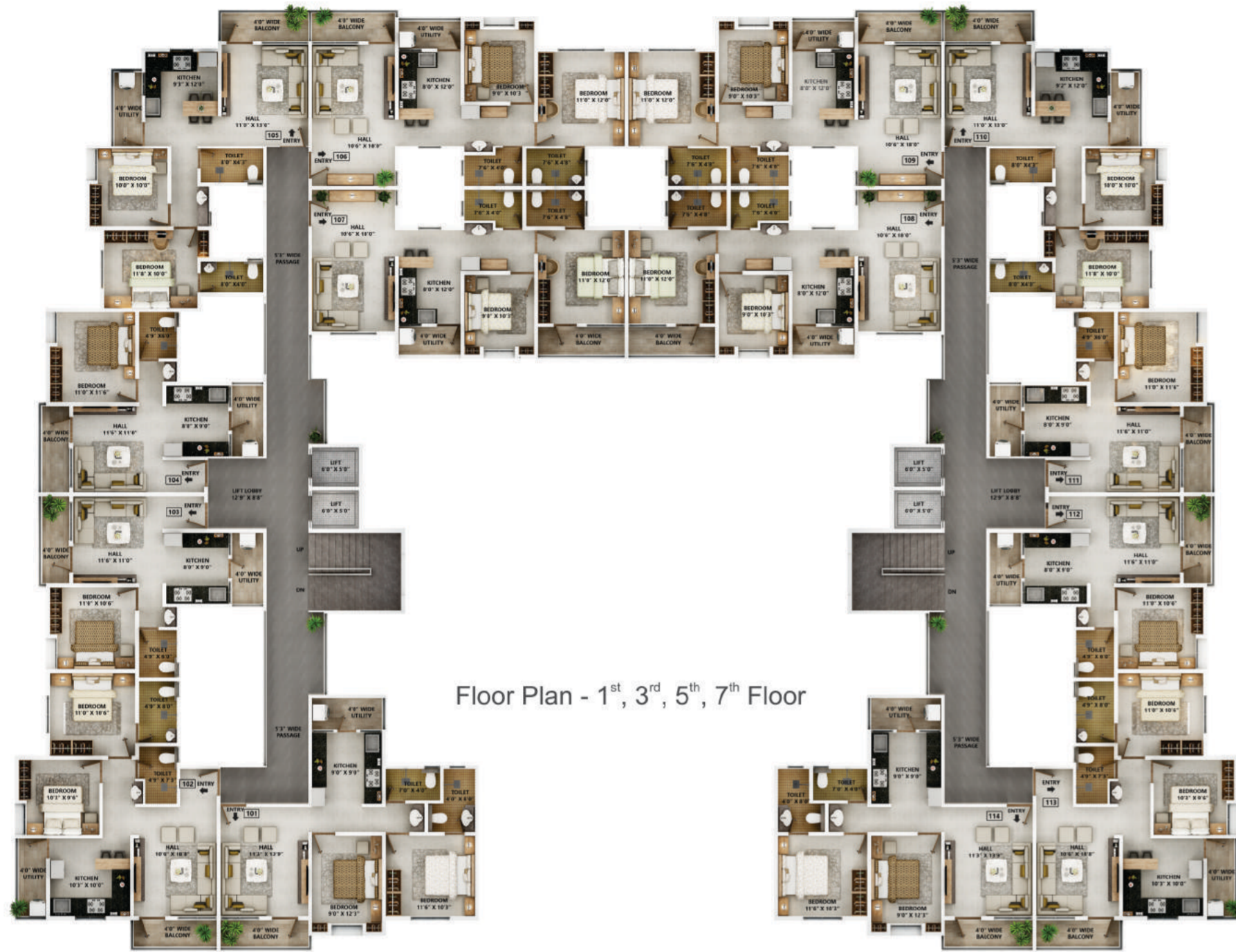

Floor Plan - 1st, 3rd, 5th, 7th Floor

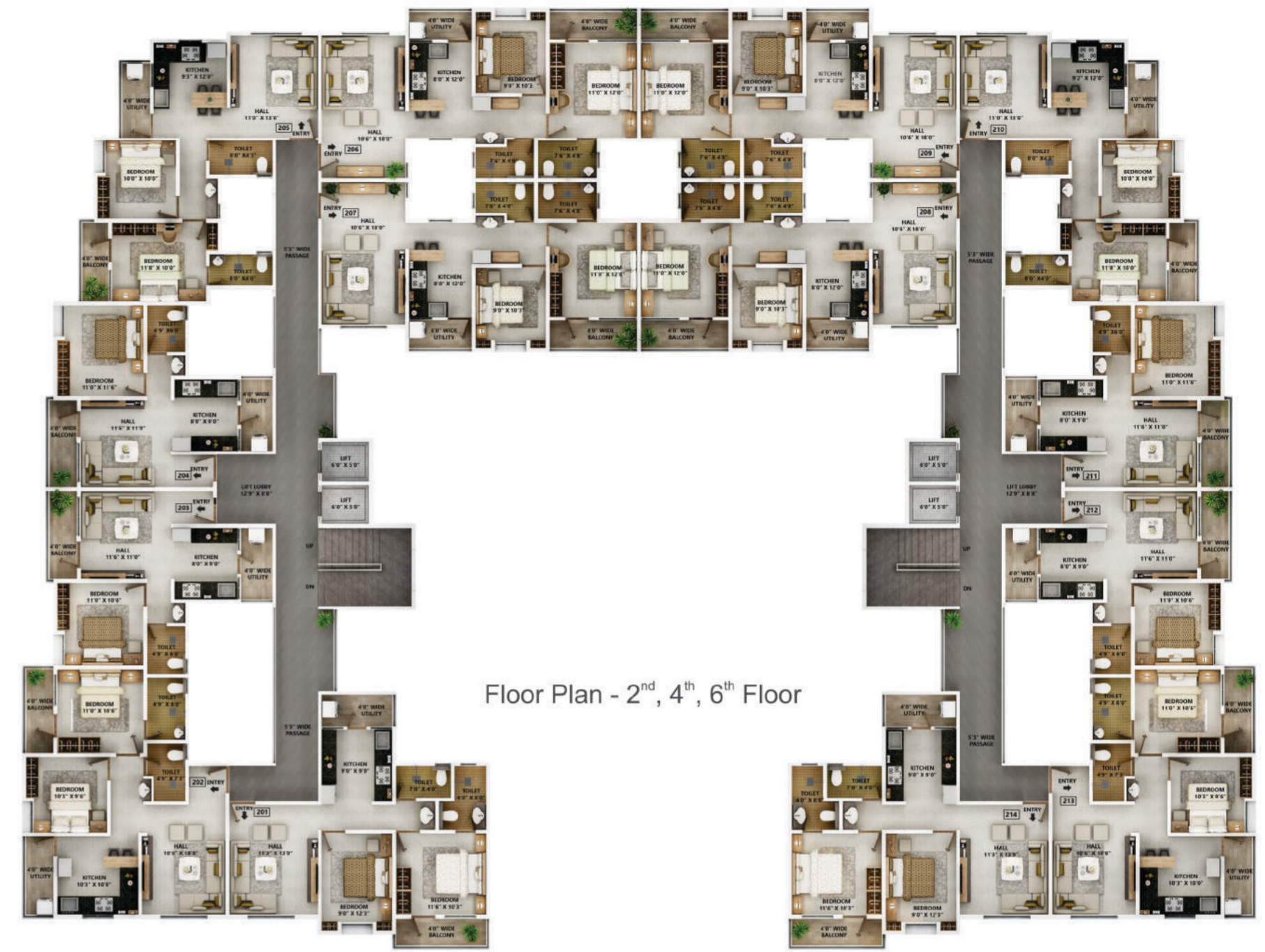

Floor Plan - 2nd, 4th, 6th Floor

Marvelous amenities at padmaveera city will make living here a pleasurable experience.



Structure & Masonry

- R.C.C. Frame structure.
- Brickwork in conventional red brick.

Kitchen

- Granite kitchen platform with stainless steel sink.
- Designer tiles dado up to lintel level over kitchen otta.
- Provisions for water purifiers & points for fridge.

Flooring

- Glazed 4x2 vitrified tiles in all rooms.
- Anti-skid ceramic flooring for toilets/bathrooms.

Doors

- Main door - Decorative entrance doors with quality fittings with wooden door decor frame.
- Toilet doors - Fiber doors with granite frame.
- Internal doors - Molded doors with plywood & cylindrical locks.

Electrification

- Concealed copper wiring.
- Modular switches in all rooms.
- Provision for AC Point in the master bedroom.
- Provision for geyser point in the bathroom.

Windows

- Powder-coated aluminum sliding windows with mosquito mesh.
- MS Grill for all windows.

Paints

- Royal paint for internal walls.
- Whether shield paint for external walls.

Toilets

- Concealed plumbing.
- Designer glazed tiles up to lintel level in all toilets.
- Hot & cold mixer units in all the toilets of standard make.
- Premium quality sanitary fittings.



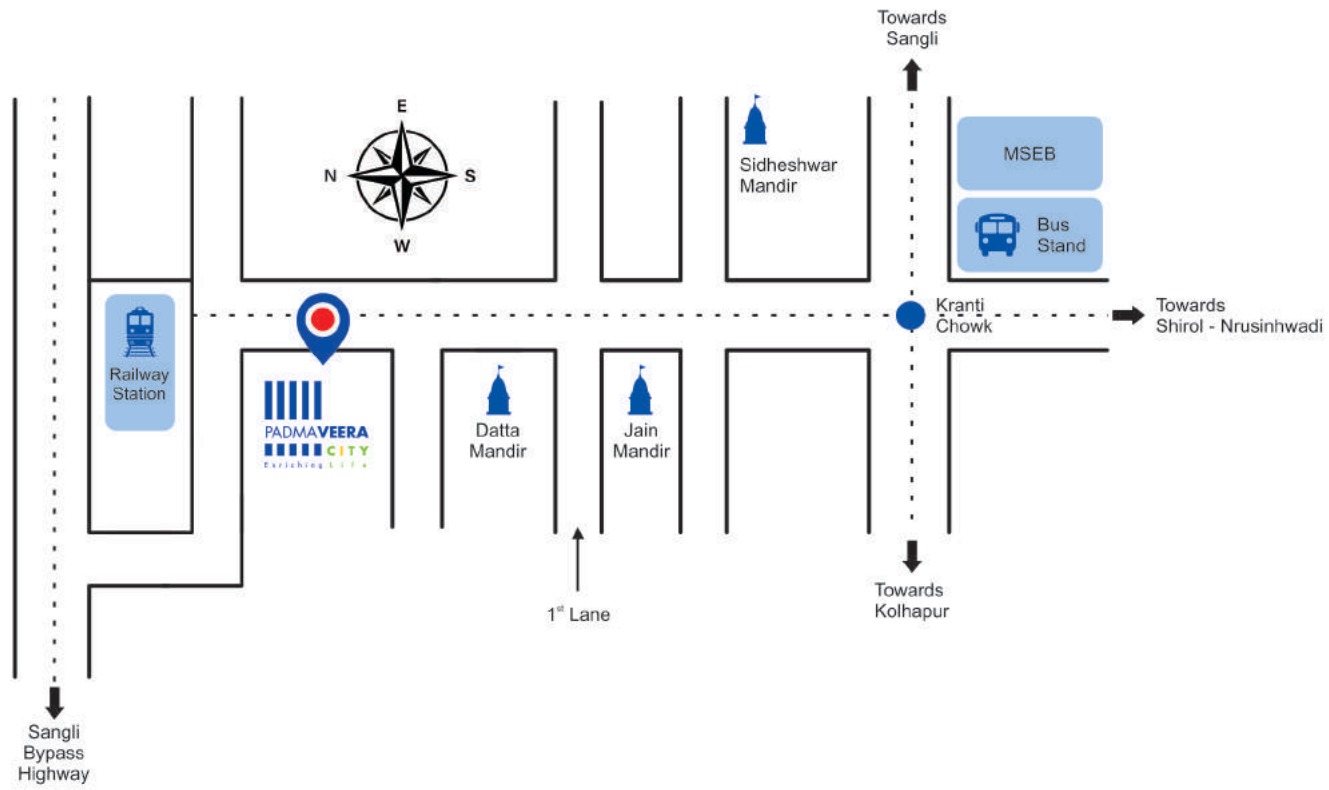

MEMBER OF
CREDAI
Rera Registered Project



P53000053009
Maha Rera Number



For More Details Call

Pradeep Patil Bhuyekar Shridhar Mohite Patil
☎ +91 9822598448 ☎ +91 9112255115

Site Add. :
Padmaveera City, 2373, K/2, Opp. Govt. Well,
Near Railway Station, Jaysingpur - 416101.

Office Add. :
Office No.-501, Emerald Corner, Rajarampuri,
2nd Lane, Kolhapur, Maharashtra, Pin-416001.
E-Mail : padmaveeraassociates@gmail.com

Architect : Preeti Girish Patil

Structural Engineer : Dr. N. K. patil

Maharera No. : P53000053009

Owner & Developer : Padmaveera Infratech